



**NIKKI KETTLE**  
*DIY expert*

# Home *projects*

Creating an office out of a small room by utilising built-in furniture, floating shelves and a tidy charging station makes space-saving sense

Photography **Anna Briggs**



## You will need

- Resene Aquaclear clear waterborne sealer
- Primer, I used Resene Quick Dry waterborne primer undercoat
- Paint colours of choice for charging station. I used Resene Enamacryl in Resene Atlas
- Sandpaper
- Circular saw
- Measuring tape
- Pencil
- Level
- Drill and drill bits
- Threaded rod or similar cut to 200mm long
- Construction glue

- (optional)
- Screws
  - Pine batten measuring 20mm x 40mm to support the desk
  - Sheet of panelling for desk. This could be thick ply or pine. I used 2400mm x 600mm x 26mm piece of plywood with an oak veneer
  - Large hole saw bit and cord tidy (from office supply store to feed cords through)
  - Basic set of drawers. I used a set of bamboo drawers for the charging station

## Built-in desk

- 1 Measure the area where you want the desk and shelves to be, marking the studs and drawing level lines.
- 2 Measure the width and depth of the space and cut the 20mm x 40mm batten to fit across the back and down the sides.
- 3 Install the batten along your level lines. Use a drill bit to pre-drill the holes, then a large wood screw to hold in place.
- 4 Measure and cut the panel for the desktop to length.
- 5 Place this onto your batten and screw down from underneath if desired. You can also use a large hole saw bit and fit a cord tidy, if desired. Cord tidy units are available from most office supply stores.
- 6 Lightly sand and finish desktop with three coats of Resene Aquaclear clear waterborne sealer.

The word custom always sounds expensive to me, but it doesn't have to be. Maximising a small space with built-in or custom furniture is a no-brainer. It could be a desk, floating shelves or charging station to use at home in a small bedroom, unused hall cupboard, nook or wardrobe.

Before building, ensure the walls and ceiling are painted or papered ahead of adding a built-in desk and installing any shelves. I painted the wall in Resene SpaceCote Flat in Resene Mineshaft and the ceiling is papered in Resene Wallpaper Collection 91273.

More Resene colours to try:



**Resene**  
Boost



**Resene**  
Boris



**Resene**  
Aoraki

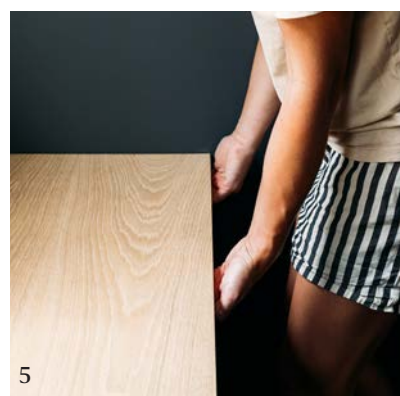
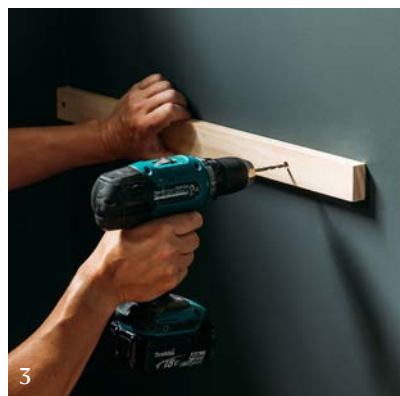



1



2

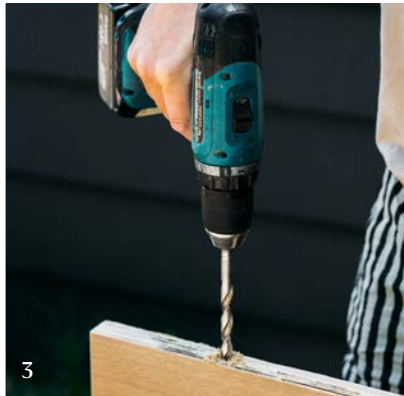

3

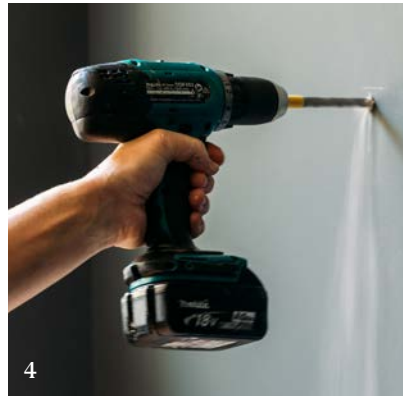

4

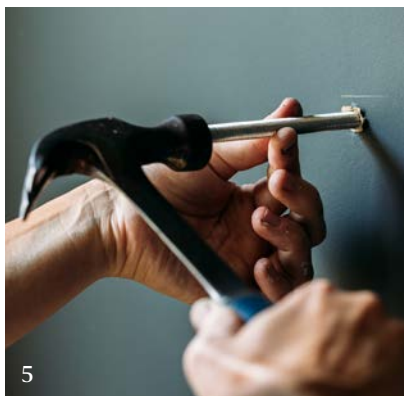

5



6

## Floating shelves

**1** Using your panel offcuts from the desktop, measure, mark and cut floating shelves. These need to be long enough to span across at least two studs to get secure fixing.

**2** Using the measurements of the studs marked earlier, mark the backs of each shelf. You want this to be nice and centre over the thickness of the shelf.

**3** Starting first with a small drill bit, drill a hole as deep as you can, then repeat this with a long 10mm drill bit (or the same diameter as your threaded rod). The deeper the rod can go in, the better.

**4** Repeat this process on the wall/studs being sure to only go as deep as the wall is thick. I have put a piece of tape around the drill bit at 90mm as a guide to stop me going too deep.



7

**5** Put a small amount of glue in each hole and press the rods in.

**6** Repeat this process with the holes in your shelves, pressing your shelf onto the rods in the wall. You may need to use a block of timber and hammer to hit it in if it is a bit tight.

**7** Lightly sand and finish shelves with three coats of Resene Aquaclear clear waterborne sealer.

## For the charging station and screen lifter

**1** Drill a hole in the back of the drawers big enough to feed your charging cables through.

**2** Lightly sand the drawers.

**3** Wipe dust off and prime with Resene Quick Dry waterborne primer undercoat.

**4** Allow to dry and apply two topcoats of your desired Resene paint colour, allowing paint to dry in between each coat. I used Resene Enamacryl in Resene Atlas.

**5** Place on desk and feed cords through the back hole, plug in devices as required and shut the draw to hide all those messy cords. This doubles as a screen riser.



1



2

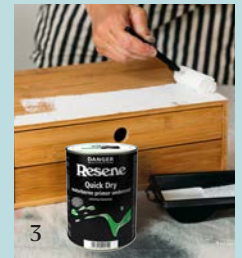

3



4



5