



You've been framed

Mark Rayner builds a simple frame for runner beans from treated timber and plastic-coated washing line.

You will need:

- Saw
- Approx 7.2m of 50mm x 50mm treated timber
- Large set square
- Pencil
- Two 1.8m metal fence stakes
- Drill with 6mm drill bit
- Six 65mm x 6mm stainless steel gutter bolts with washers and nuts
- Exterior PVA glue
- Small adjustable wrench or socket set
- Galvanised fencing staples
- Hammer
- Approx 20m of plastic coated washing line
- Paintbrush
- Resene Woodsman penetrating oil stain in Resene Fern Frond



1 CUT the 50mm x 50mm timber into four 1.8m lengths.



2 USE an offcut of the 50mm timber to mark a straight pencil line around each end of the four lengths of timber. Draw a second central line dissecting this at 90 degrees, as shown.



3 CAREFULLY saw halfway through each end of the timber using the first pencil line as a guide. Turn and saw back along the second pencil line, to remove a small rectangular piece of wood to form each corner joint.

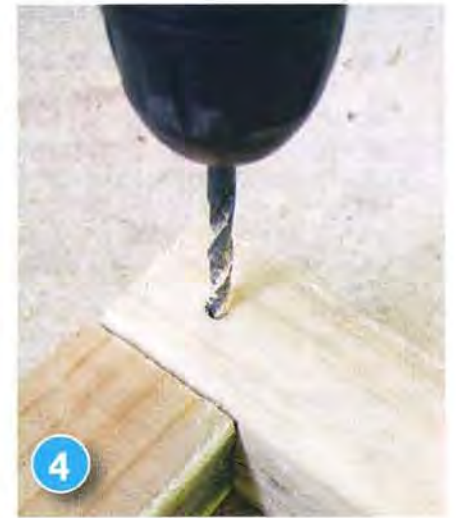

4 LAY the frame on a flat surface and overlap the top corners. Drill through with a 6mm drill bit.

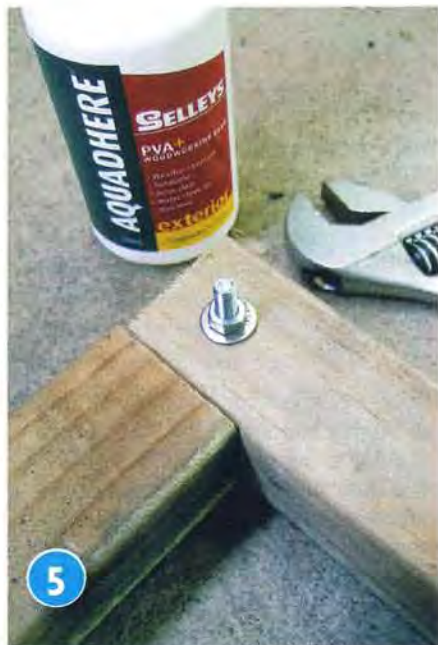

5 FIX both top corners with PVA glue and a stainless steel gutter bolt. Use the set square to ensure each corner is 90 degrees.



6 OVERLAP the two bottom corners in the same way and position the metal fence stakes along each side, aligning the lowermost hole (in the fence stake) with the corner of the frame. Drill through this hole and bolt through the corner joint as in step five. Drill through the uppermost hole and fix to the frame with a bolt, as shown.



7 USING galvanised staples and a hammer, attach the washing line in an up-and-down, zigzag formation, about 155mm apart.



8 STAIN the outer frame with one coat of Resene Woodsman, and allow 24 hours to dry before applying a second coat.

Finishing off

TO position the bean frame, simply tap the metal fence stakes into the ground with a hammer or mallet, checking that it's upright and level with a spirit level, then plant your beans.